



HLS gen 4

integrated lighting



Award
Winning
Design

HLS Gen4 - Setting the Standard for Integrated LED Lighting

The multi-award winning HLS minipuck is the most flexible and vandal resistant LED handrail lighting module on the market, offering unrivalled uniformity and photometric performance. Designed with the specifier in mind, it accommodates a wide range of options of beams, CCT, colour, dimming protocols, emergency and solar alternatives.

The minipucks can be installed in new handrail or retrofitted into existing handrail, flat or oval metallic structures and surfaces. It is powerful, yet small and unobtrusive, making the minipuck ideal for incorporation into street sculptures, illuminating artwork or to wash walls with white or RGB light.

The HLS Gen4 minipuck is made in electropolished 316 stainless steel, with options of brass, painted finishes including aged bronze patina, aluminium and super-duplex stainless steel, which offers exceptional corrosion resistance.

To date, the majority of HLS installations are in public areas, as one of the main features of the minipuck is vandal resistance. The thread locking mechanism of the HLS minipuck and the unique tool required for removal prevents vandalism and theft. The fixture achieves the highest impact rating available; IK10 - European Standard EN62262.

The Planet Lighting HLS minipuck is the most widely specified LED module based handrail system in the world, with over 100,000 minipucks installed since 2006, ranging across locations in the United States, Canada, UK, France, Germany, Ireland, Holland, Sweden, Serbia, United Arab Emirates, Hong Kong, Singapore, Malaysia, India, New Zealand and Australia.

HLS Gen4 is 100% Made in Australia

'Concrete Transcendence' Stockholm, Sweden

Urban Artwork

Ebba Bohlin 2012



Features of HLS Gen4

- 316 electropolished stainless steel LED module
- fits \varnothing 38-100mm handrail
- custom curvature available eg. \varnothing 25mm
- any metallic surface (minimum wall thickness 1.5mm)
- up to 150 lumens
- 100 lumens/watt
- 1.5W
- IP67
- 95% glare reduction*
- available in three beams
standard
asymmetric
symmetric
- Standard colour temperatures:
 - 2700K, 3000K, 4000K, 5000K
 - custom colours & RGB available
- any dimming protocol
- polycarbonate or borosilicate lens
- custom lensing available
- vandal resistant design
- IK10 (EN62262)
- easy and fast retrofit into existing handrail or surface
- emergency compatible
- stand alone solar PV solutions
- UL listing pending

*compared to Gen3



Brixton Windrushes
London, England
Street Sculpture

HLS minipuck beam types

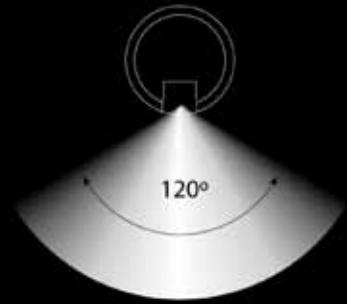
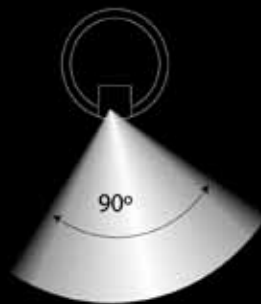
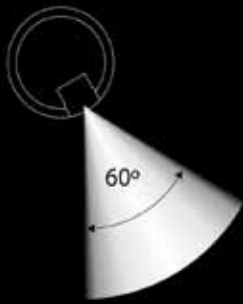

Standard

- 20-30° orientation in rail
- highest efficiency
- very little loss of light
- minimal spill of light onto wall

Vertical Down Asymmetric

- 90° vertical down orientation in rail
- some wall wash

Vertical Down Symmetric

- 120° vertical down orientation in rail
- perfect for mid-rails

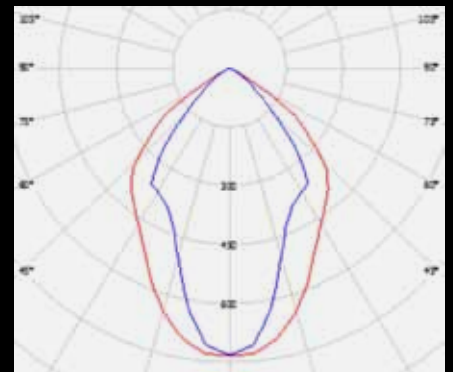
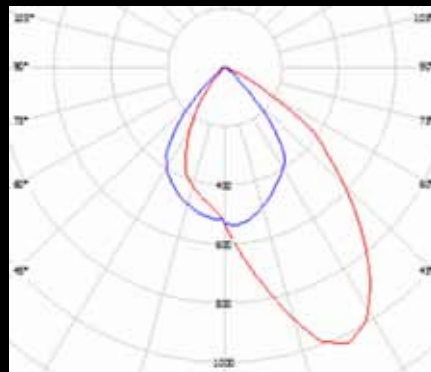
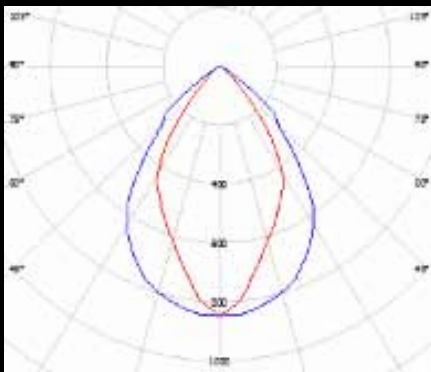

3000K Standard beam
0.5m centres, 2m wide stair
Average 200 lux
Uniformity 0.67

3000K Asymmetric beam
0.5m centres, 2m wide stair
Average 150 lux
Uniformity 0.64

3000K Symmetric beam
0.5m centres, mid-rail
Average 100 lux
Uniformity 0.25

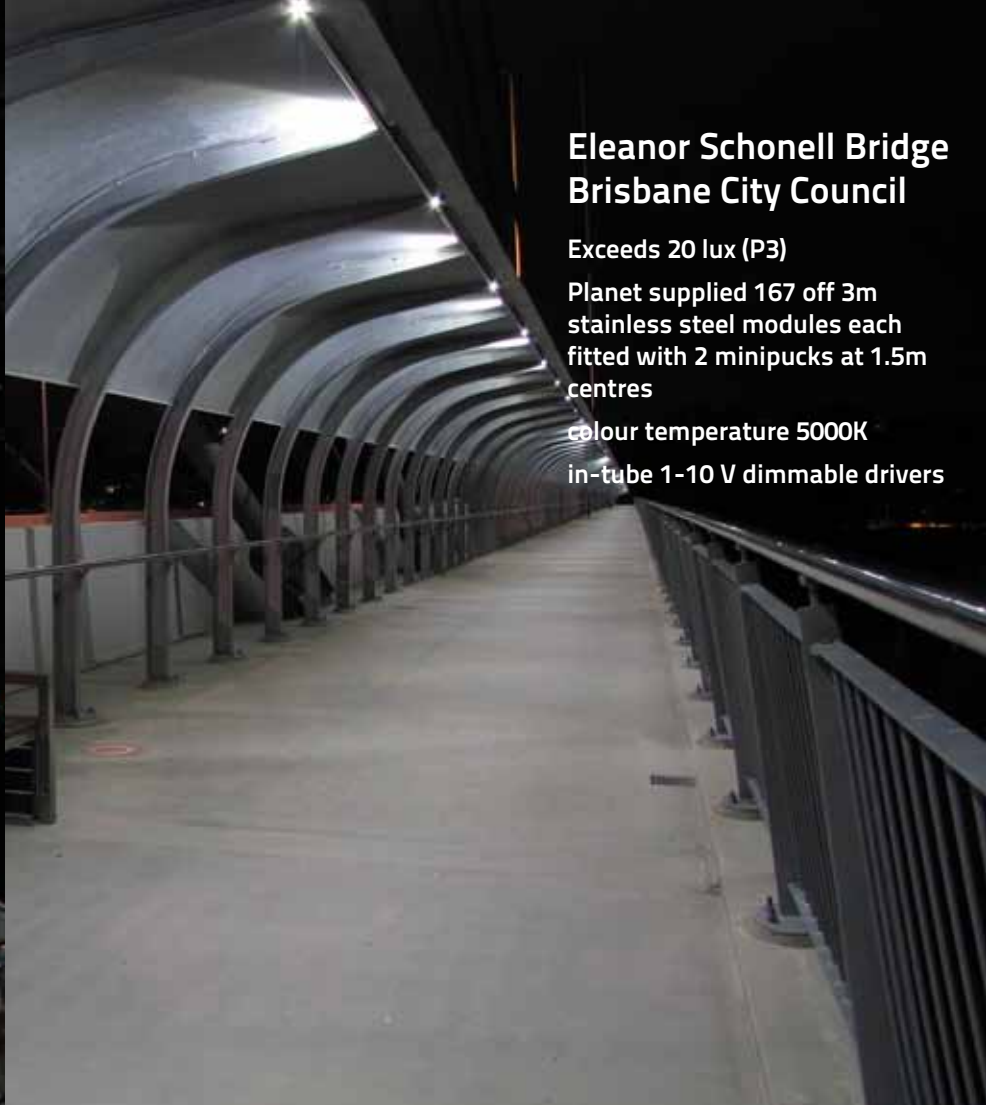

Eleanor Schonell Bridge Brisbane City Council

Exceeds 20 lux (P3)

Planet supplied 167 off 3m stainless steel modules each fitted with 2 minipucks at 1.5m centres

colour temperature 5000K

in-tube 1-10 V dimmable drivers

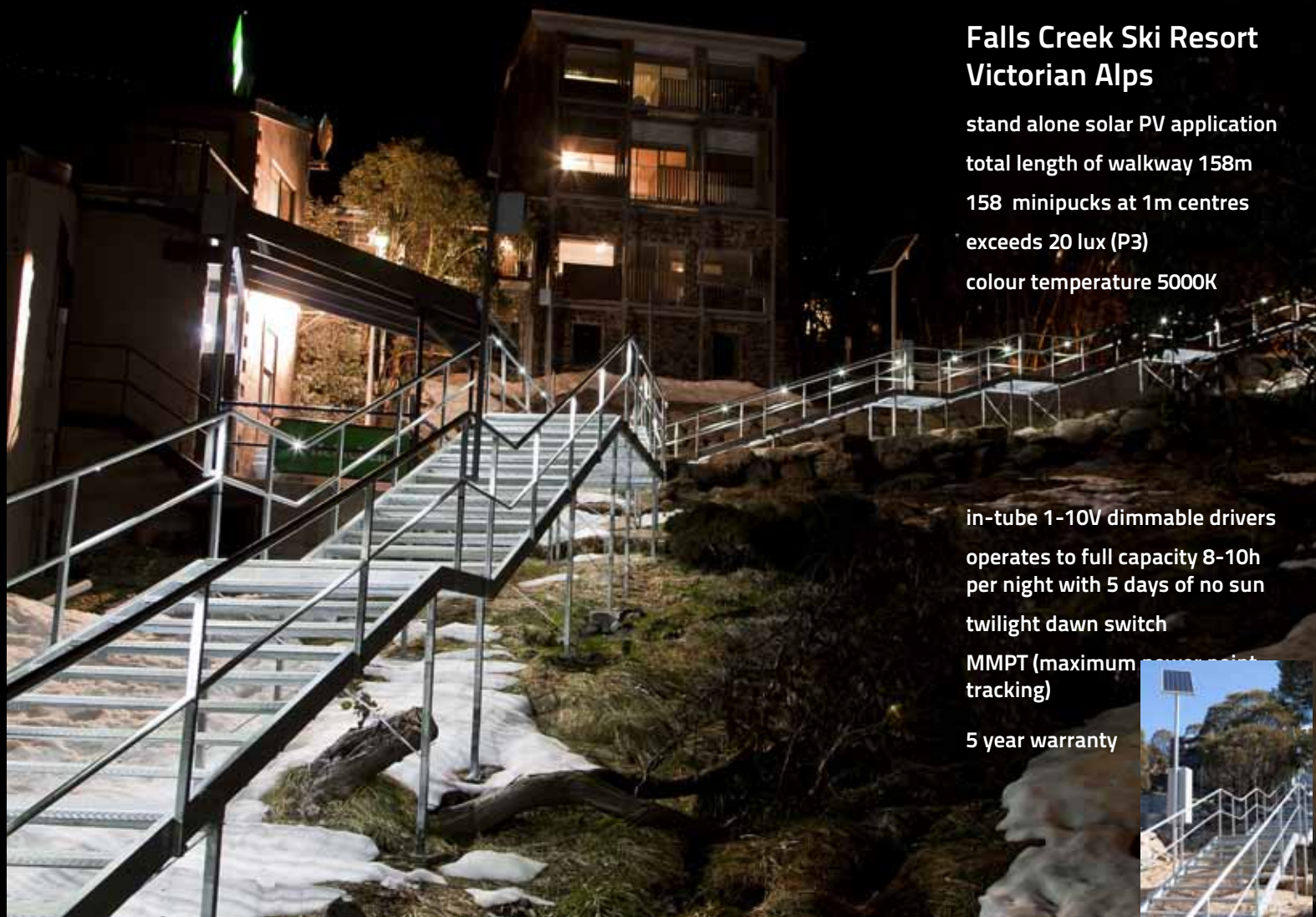

Falls Creek Ski Resort Victorian Alps

stand alone solar PV application

total length of walkway 158m

158 minipucks at 1m centres

exceeds 20 lux (P3)

colour temperature 5000K

in-tube 1-10V dimmable drivers

operates to full capacity 8-10h

per night with 5 days of no sun

twilight dawn switch

MMPT (maximum power point tracking)

5 year warranty





HLS minipuck thread types

(handrail/material wall thickness)

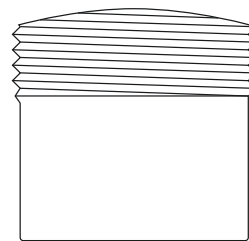
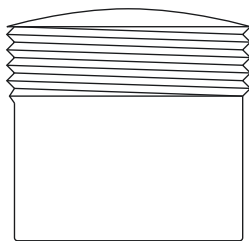

Heavy Wall Handrail

- equipped with a shoulder designed to fit into a 1.8mm counterbored hole
- Suitable for handrail wall thickness 2.5mm or greater.

Thin Wall Handrail

- threaded to the top ensuring sufficient purchase in thinner walled applications.
- Suitable for handrail wall thickness 1.5mm or greater.



HLS minipuck face types

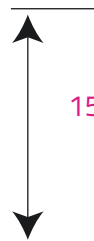
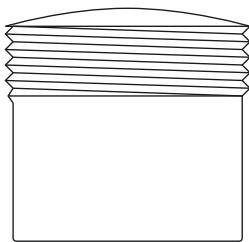

15mm

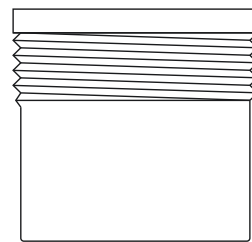

Curved Face

- fits \varnothing 38-100mm rail standard
- custom versions available eg. \varnothing 25mm
- minimum wall thickness 1.5mm

Flat Faced

- suitable for flat metallic surfaces and structures
- minimum wall thickness 1.5mm

Sir James Mitchell Park
Perth Foreshore, Swan River
Perth City Council



Colour temperatures/Colours

Standard: 2700K 3000K 4000K 5000K

On request: Solid colours, RGB

Driver solutions

Standard: 1-10V or Push Dim
Drives 1-30 minipucks @ 500mA

Other dimming protocols available:
DMX, DALI, DSI, Leading/trailing edge phase



Dubai Metro, UAE Red & Green Line

40 stations

200 lux minimum required

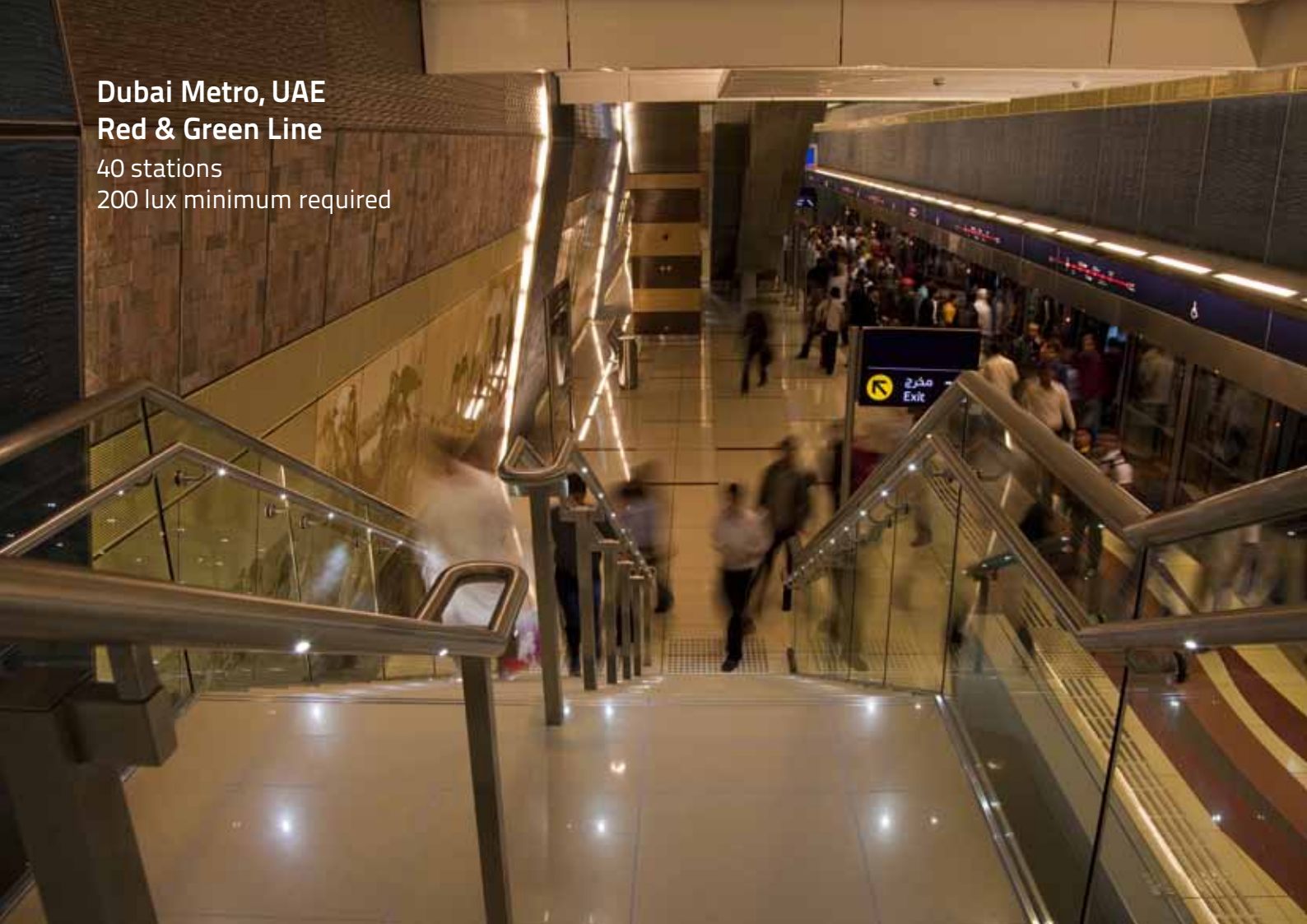

Internal Wiring

Series wiring to shunt protected minipucks - limits unlikely fail to single LED without compromising integrity of the circuit

100% water proof connections

Wire distances and sizes

wire size max OD 2.08mm

<100m - 0.5mm²

<150m - 0.75mm²

<200m - 1mm²

<250m - 1.5mm²

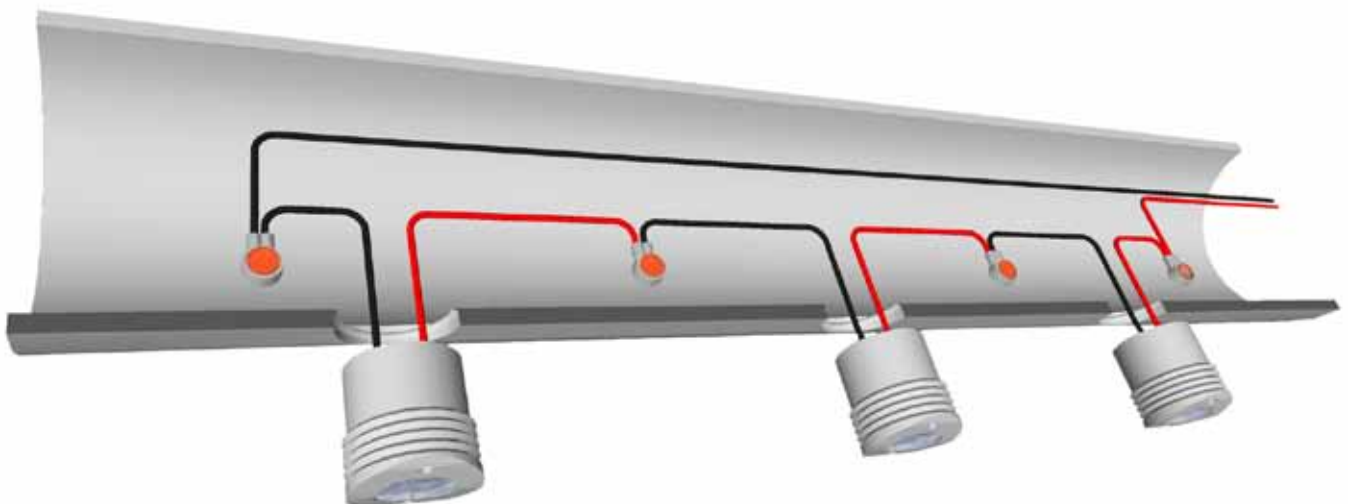

Retro-fit or new installation



HLS Gen4 drill jig equipment (patent pending):

- accurate
- simple
- fast

on site drilling of handrail for easy retro fit or new installations.

The key to a successful installation is having the right tool for the job.

Over the last half-decade Planet Lighting has progressively developed and improved the HLS drill-jig equipment and support. The Gen4 drill-jig enables installers without previous experience of metal work to align, drill, counterbore and tap holes with precision and speed.

For peace of mind, Planet Lighting offers:

- full installation service
- installation supervision
- telephone/online support

Available worldwide via our distributors

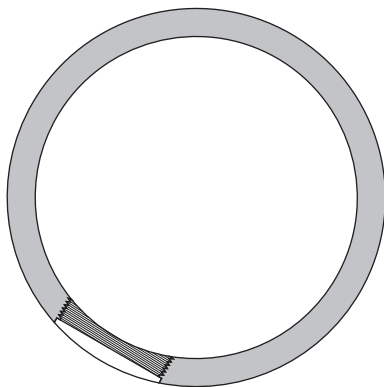

Heavy Wall Minipucks

- \varnothing 15mm drilled hole
- \varnothing 16 x 1.8mm counterbore
- tapped M16x1

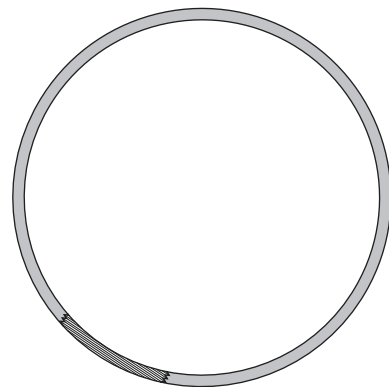

Thin Wall Minipucks

- \varnothing 15mm drilled hole
- tapped M16x1

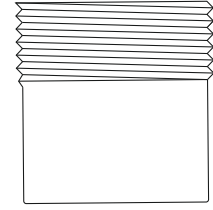
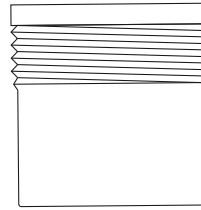
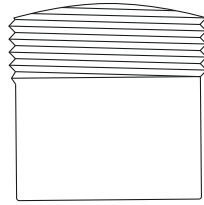
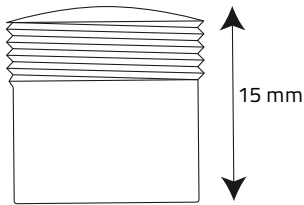

Heavy Wall Curved Face

- $\varnothing 38$ -100mm pipe
- wall thickness >2.5mm
- 15mm hole with $\varnothing 16$ mm x 1.8mm counterbore
- M16 x 1 internal thread

Thin Wall Curved Face

- $\varnothing 38$ -100mm pipe
- wall thickness >1.5mm
- 15mm hole
- M16 x 1 internal thread

Heavy Wall Flat Face

- Flat surface
- wall thickness >2.5mm
- 15mm hole with $\varnothing 16$ mm x 1.8mm counterbore
- M16 x 1 internal thread

Thin Wall Flat Face

- Flat surface
- wall thickness >1.5mm
- 15mm hole
- M16 x 1 internal thread

Lighting Data

LED Quantity	1
LED type	Cree
Power	1.5W
Colour temperature	Lumen output
5000K	148
4000K	137
3000K	127
2700K	118

Electrical Data

Input current	500mA
Vf	3V
Driver	Maxi Jolly HV 1-30 minipucks in series
Connection	waterproof gel filled connector
Wire size and distances	max OD 2.08mm
	<100m - 0.5mm ²
	<150m - 0.75mm ²
	<200m - 1mm ²

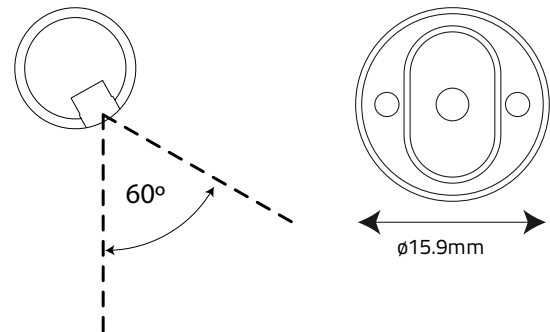

Fixture data

Metalware standard	316 stainless steel	
Metalware option	aluminium, brass, aged bronze patina, paint finish, hyper-duplex stainless steel	
Lens standard	polycarbonate lens	
Lens option	borosilicate lens	
IP rating	IP66	polycarbonate lens
	IP67	borosilicate lens
Impact rating	IK10 (polycarbonate lens)	
Ambient temperature	55°C	
Warranty	5 years	

Standard Beam Heavy wall suitable for wall thickness >2.5mm Curved Face $\varnothing 38$ -1000mm handrail pipe

HLS-ST-HW-CF-DW	Standard, Heavy Wall, Curved, Face, 5000K
HLS-ST-HW-CF-NW	Standard, Heavy Wall, Curved Face, 4000K
HLS-ST-HW-CF-WW	Standard, Heavy Wall, Curved Face, 3000K
HLS-ST-HW-CF-IW	Standard, Heavy Wall, Curved, Face 2700K

Standard Beam Thin wall suitable for wall thickness >1.5mm Curved Face $\varnothing 38$ -1000mm handrail pipe

HLS-ST-TW-CF-DW	Standard, Thin Wall, Curved, Face 5000K
HLS-ST-TW-CF-NW	Standard, Thin Wall, Curved Face, 4000K
HLS-ST-TW-CF-WW	Standard, Thin Wall, Curved Face, 3000K
HLS-ST-TW-CF-IW	Standard, Thin Wall, Curved Face, 2700K

Standard Beam Heavy wall suitable for wall thickness >2.5mm Flat Face Surface

HLS-ST-HW-FF-DW	Standard, Heavy Wall, Flat Face, 5000K
HLS-ST-HW-FF-NW	Standard, Heavy Wall, Flat Face, 4000K
HLS-ST-HW-FF-WW	Standard, Heavy Wall, Flat Face, 3000K
HLS-ST-HW-FF-IW	Standard, Heavy Wall, Flat Face, 2700K

Standard Beam Thin wall suitable for wall thickness >1.5mm Flat Face Surface

HLS-ST-TW-FF-DW	Standard, Thin Wall, Flat Face, 5000K
HLS-ST-TW-FF-NW	Standard, Thin Wall, Flat Face, 4000K
HLS-ST-TW-FF-WW	Standard, Thin Wall, Flat Face, 3000K
HLS-ST-TW-FF-IW	Standard, Thin Wall, Flat Face, 2700K

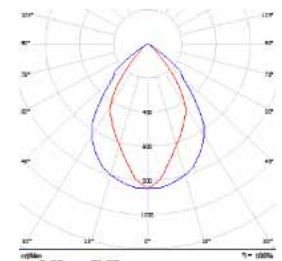

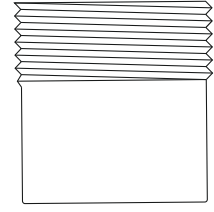
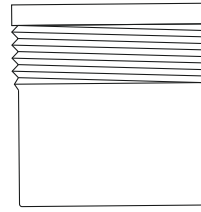
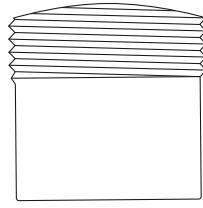
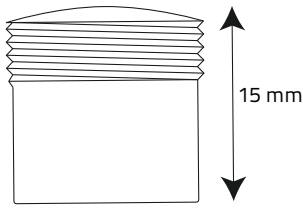

Heavy Wall Curved Face

- $\varnothing 38$ -100mm pipe
- wall thickness >2.5mm
- 15mm hole with $\varnothing 16$ mm x 1.8mm counterbore
- M16 x 1 internal thread

Thin Wall Curved Face

- $\varnothing 38$ -100mm pipe
- wall thickness >1.5mm
- 15mm hole
- M16 x 1 internal thread

Heavy Wall Flat Face

- Flat surface
- wall thickness >2.5mm
- 15mm hole with $\varnothing 16$ mm x 1.8mm counterbore
- M16 x 1 internal thread

Thin Wall Flat Face

- Flat surface
- wall thickness >1.5mm
- 15mm hole
- M16 x 1 internal thread

Lighting Data

LED Quantity	1
LED type	Cree
Power	1.5W
Colour temperature	Lumen output
5000K	140
4000K	130
3000K	119
2700K	110

Electrical Data

Input current	500mA
Vf	3V
Driver	Maxi Jolly HV 1-30 minipucks in series
Connection	waterproof gel filled connector
Wire size and distances	max OD 2.08mm
	<100m - 0.5mm ²
	<150m - 0.75mm ²
	<200m - 1mm ²
	<200m - 1.5mm ²

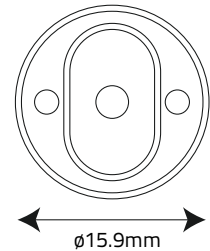
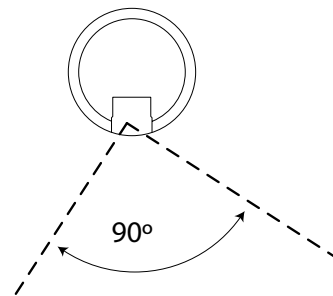

Fixture data

Metalware standard	316 stainless steel	
Metalware option	aluminium, brass, aged bronze patina, paint finish, hyper-duplex stainless steel	
Lens standard	polycarbonate lens	
Lens option	borosilicate lens	
IP rating	IP66	polycarbonate lens
	IP67	borosilicate lens
Impact rating	IK10 (polycarbonate lens)	
Ambient temperature	55°C	
Warranty	5 years	

Assymmetric Beam Heavy wall suitable for wall thickness >2.5mm Curved Face $\varnothing 38$ -1000mm handrail pipe

HLS-VA-HW-CF-DW	Standard, Heavy Wall, Curved, Face, 5000K
HLS-VA-HW-CF-NW	Standard, Heavy Wall, Curved Face, 4000K
HLS-VA-HW-CF-WW	Standard, Heavy Wall, Curved Face, 3000K
HLS-VA-HW-CF-IW	Standard, Heavy Wall, Curved, Face, 2700K

Assymmetric Beam Thin wall suitable for wall thickness >1.5mm Curved Face $\varnothing 38$ -1000mm handrail pipe

HLS-VA-TW-CF-DW	Standard, Thin Wall, Curved, Face, 5000K
HLS-VA-TW-CF-NW	Standard, Thin Wall, Curved Face, 4000K
HLS-VA-TW-CF-WW	Standard, Thin Wall, Curved Face, 3000K
HLS-VA-TW-CF-IW	Standard, Thin Wall, Curved Face, 2700K

Assymmetric Beam Heavy wall suitable for wall thickness >2.5mm Flat Face Surface

HLS-VA-HW-FF-DW	Standard, Heavy Wall, Flat Face, 5000K
HLS-VA-HW-FF-NW	Standard, Heavy Wall, Flat Face, 4000K
HLS-VA-HW-FF-WW	Standard, Heavy Wall, Flat Face, 3000K
HLS-VA-HW-FF-IW	Standard, Heavy Wall, Flat Face, 2700K

Assymmetric Beam Thin wall suitable for wall thickness >1.5mm Flat Face Surface

HLS-VA-TW-FF-DW	Standard, Thin Wall, Flat Face, 5000K
HLS-VA-TW-FF-NW	Standard, Thin Wall, Flat Face, 4000K
HLS-VA-TW-FF-WW	Standard, Thin Wall, Flat Face, 3000K
HLS-VA-TW-FF-IW	Standard, Thin Wall, Flat Face, 2700K

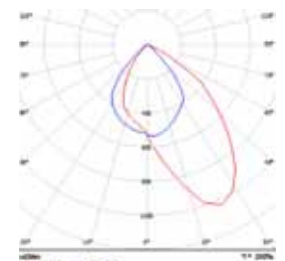

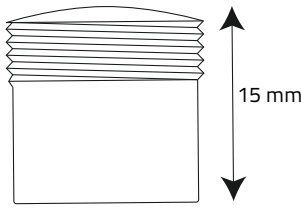

Heavy Wall Curved Face

- $\varnothing 38$ -100mm pipe
- wall thickness >2.5mm
- 15mm hole with $\varnothing 16$ mm x 1.8mm counterbore
- M16 x 1 internal thread

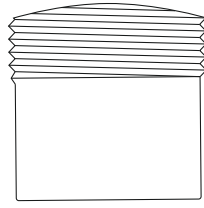

Thin Wall Curved Face

- $\varnothing 38$ -100mm pipe
- wall thickness >1.5mm
- 15mm hole
- M16 x 1 internal thread

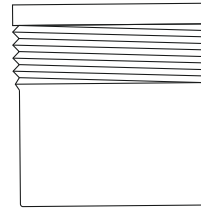

Heavy Wall Flat Face

- Flat surface
- wall thickness >2.5mm
- 15mm hole with $\varnothing 16$ mm x 1.8mm counterbore
- M16 x 1 internal thread

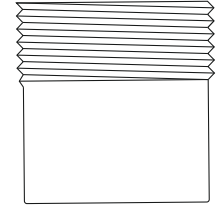

Thin Wall Flat Face

- Flat surface
- wall thickness >1.5mm
- 15mm hole
- M16 x 1 internal thread

Lighting Data

LED Quantity	1
LED type	Cree
Power	1.5W
Colour temperature	Lumen output
5000K	154
4000K	143
3000K	125
2700K	123

Electrical Data

Input current	500mA
Vf	3V
Driver	Maxi Jolly HV 1-30 minipucks in series
Connection	waterproof gel filled connector
Wire size and distances	max OD 2.08mm
	<100m - 0.5mm ²
	<150m - 0.75mm ²
	<200m - 1mm ²
	<200m - 1.5mm ²

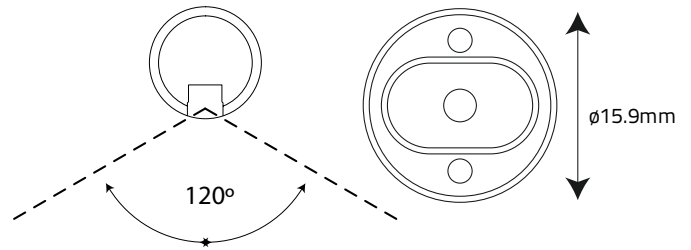

Fixture data

Metalware standard	316 stainless steel	
Metalware option	aluminium, brass, aged bronze patina, paint finish, hyper-duplex stainless steel	
Lens standard	polycarbonate lens	
Lens option	borosilicate lens	
IP rating	IP66	polycarbonate lens
	IP67	borosilicate lens
Impact rating	IK10 (polycarbonate lens)	
Ambient temperature	55°C	
Warranty	5 years	

Symmetric Beam Heavy wall suitable for wall thickness >2.5mm Curved Face $\varnothing 38$ -1000mm handrail pipe

HLS-VS-HW-CF-DW	Standard, Heavy Wall, Curved, Face, 5000K
HLS-VS-HW-CF-NW	Standard, Heavy Wall, Curved Face, 4000K
HLS-VS-HW-CF-WW	Standard, Heavy Wall, Curved Face, 3000K
HLS-VS-HW-CF-IW	Standard, Heavy Wall, Curved, Face 2700K

Symmetric Beam Thin wall suitable for wall thickness >1.5mm Curved Face $\varnothing 38$ -1000mm handrail pipe

HLS-VS-TW-CF-DW	Standard, Thin Wall, Curved, Face 5000K
HLS-VS-TW-CF-NW	Standard, Thin Wall, Curved Face, 4000K
HLS-VS-TW-CF-WW	Standard, Thin Wall, Curved Face, 3000K
HLS-VS-TW-CF-IW	Standard, Thin Wall, Curved Face, 2700K

Symmetric Beam Heavy wall suitable for wall thickness >2.5mm Flat Face Surface

HLS-VS-HW-FF-DW	Standard, Heavy Wall, Flat Face, 5000K
HLS-VS-HW-FF-NW	Standard, Heavy Wall, Flat Face, 4000K
HLS-VS-HW-FF-WW	Standard, Heavy Wall, Flat Face, 3000K
HLS-VS-HW-FF-IW	Standard, Heavy Wall, Flat Face, 2700K

Symmetric Beam Thin wall suitable for wall thickness >1.5mm Flat Face Surface

HLS-VS-TW-FF-DW	Standard, Thin Wall, Flat Face, 5000K
HLS-VS-TW-FF-NW	Standard, Thin Wall, Flat Face, 4000K
HLS-VS-TW-FF-WW	Standard, Thin Wall, Flat Face, 3000K
HLS-VS-TW-FF-IW	Standard, Thin Wall, Flat Face, 2700K

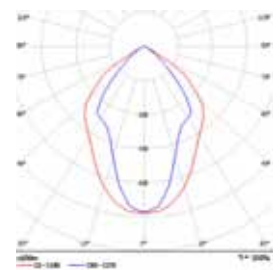

**Ardrey Memorial Auditorium
Northern Arizona University College of Arts
Flagstaff, USA**



**60 St. Martins Lane
London, England
200 lux, DALI dimmable**



Swanston Street
Melbourne, City Council, Australia
Integrated under-seat lighting with integral driver



Bridge over Strömsån
Strömstad, Sweden
Curved handrail application

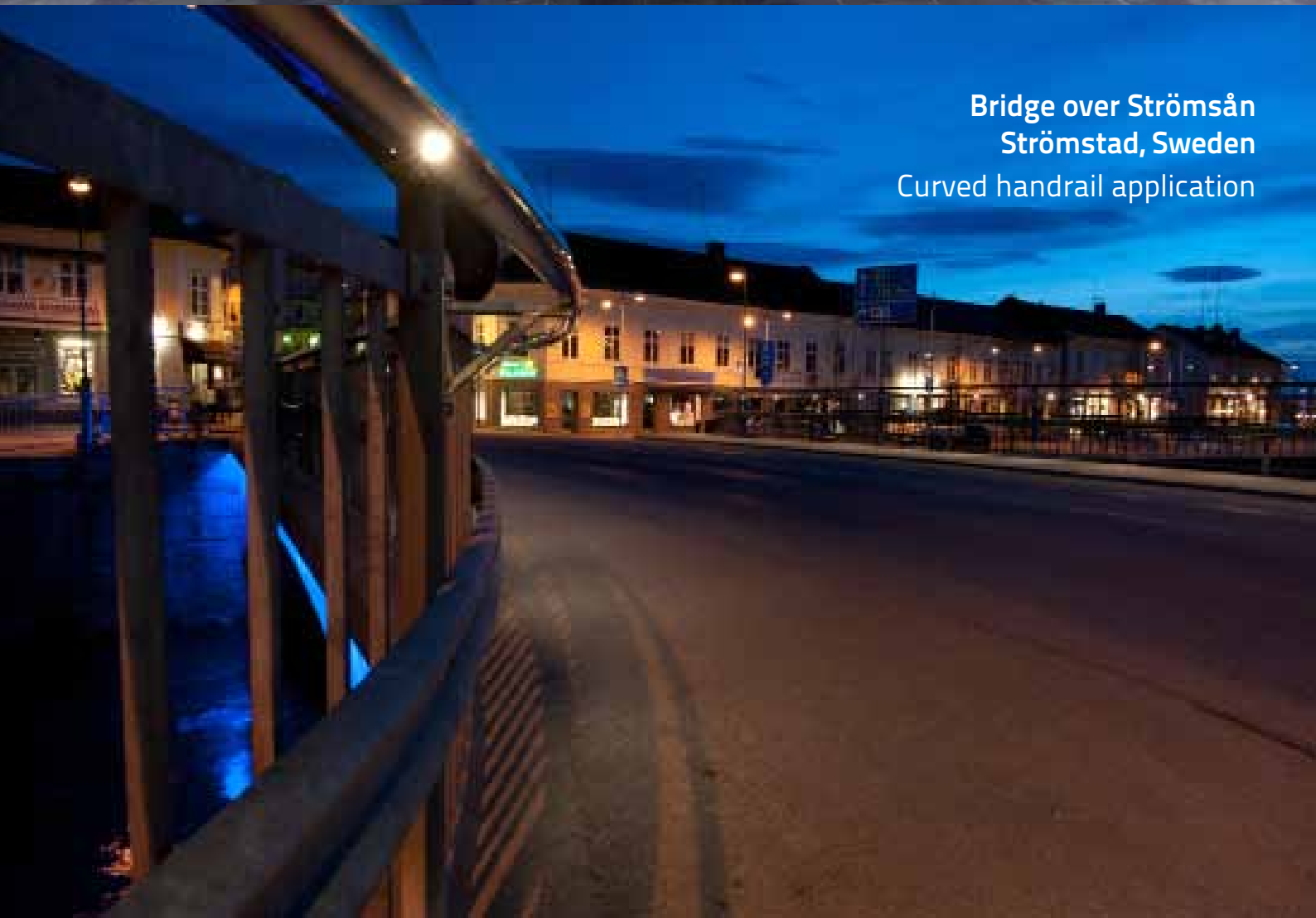

DISTRIBUTORS

AUSTRALIA

VICTORIA

Louise Reynolds
Planet Lighting
Victorian State Manager
louise@planetlighting.com
Phone: 0422 017 060
Fax: 03 9481 8030

NEW SOUTH WALES

The Lighting Group Pty Ltd
18A 380 Eastern Valley way
Chatswood NSW 2067
sales@lightinggroup.com
Phone : 02 9882 6000
Fax: 02 9882 6444

WESTERN AUSTRALIA

Inlite
344 Hay Street
Subiaco WA 6008
wa@inlite.com.au
Phone: 08 9227 0444
Fax: 08 9227 1544

SOUTH AUSTRALIA

Moonlighting
101 Port Wakefield Rd
Cavan SA 5094
moonsa@moonlighting.com.au
Phone: 08 8139 7350
Fax: 08 8139 7355

ACT

Lite-Tech Agencies
1 Lithgow Street
Fyshwick ACT 2609
sales@litetech.com.au
Phone: 02 6280 5516
Fax: 02 6280 8635

TASMANIA

Undersea Lighting
54 Conningham Rd
Conningham TAS 7054
De_T@bigpond.com
Phone: 03 6267 9530
Fax: 03 6267 9523

NORTHERN TERRITORY

Moonlighting
101 Port Wakefield Rd
Cavan SA 5094
moonsa@moonlighting.com.au
Phone: 08 8139 7350
Fax: 08 8139 7355

QUEENSLAND

The Lighting Group Pty Ltd
Shop 2, 47 Castlemaine Street
Milton QLD 4064
sales@lightinggroup.com
Phone: 07 3876 4009
Fax: 07 3369 4007

FAR NORTH QUEENSLAND

North Queensland Lighting
69C Sheridan Street
Cairns QLD 4870
nql@tpg.com.au
Phone: 07 4031 4490
Fax: 07 4031 5933

NEW ZEALAND

Concept Lighting Pty Ltd
60 Apollo Drive
Mairangi Bay
Auckland
info@conceptlighting.co.nz
Phone: +64 9 917 9200
Fax: +64 9 917 9207

EUROPE

WILA Lichttechnik GmbH
Vödeweg 9-11
D-58638
Iserlohn
wila@wila.com
Phone: + 49 - 23 71 823 0
Fax: + 49 - 23 71 823 222

CANADA

7940, Jean-Brillon
Québec , Montréal
Canada H8N 2L5
info@lumid.com
Phone: (514) 524-1831
Fax: (514) 524-2409

HONG KONG

William Artists International
3/F ShingDao Industrial Building
232 Aberdeen Main Rd
Aberdeen, Hong Kong
waal@williamartists.com
Phone: + 852 2870 2288
Fax: + 852 2552 2787

UK & IRELAND

WILA Lighting Limited
8-10 The Quadrangle
Grove Technology Park
Downsview Road
Wantage OX12 9FA UK
wila@wila.co.uk
Phone: +44 1235 77 3500
Fax: +44 1235 77 35 33

UAE & SERBIA

Gulf Line International
PO Box 40855
Dubai, UAE
info@gulfline.ae
Ph. +971 4 222 6 226
Fax: +971 4 222 6 227

SINGAPORE

Technolite
25 Tagore Lane #03-10
Singapore Godown
Singapore 787602
enquiry@technolite.com.sg
DID: +65-63099783
Fax: +65-64531908

SWEDEN & NORDIC

Fox Design AB
Tellusgängen 8
SE-126 26 Hägersten
Stockholm
info@foxdesign.se
Phone: +46 8 440 85 40
Fax: +46 8 24 22 33

UNITED STATES

Lummen-Lighting ByDesign
237 Talbot Avenue
Santa Ros CA 95450
hg@lummenlighting.com
Phone: +1 707-360-5428
Fax: 707-595-4583
Cell: +1 707-206-1617



12 Tamarind Drive PO Box 231
Bellingen NSW 2454 Australia
Ph + 61 2 6659 5600
Fax + 61 2 6655 2121
www.planetlighting.com
info@planetlighting.com



Award
Winning
Design