

www.planetlighting.com

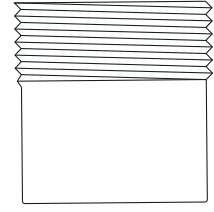
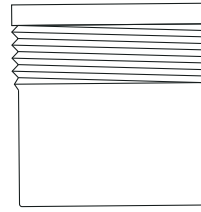
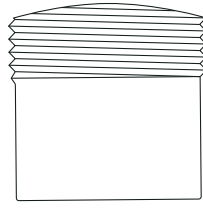
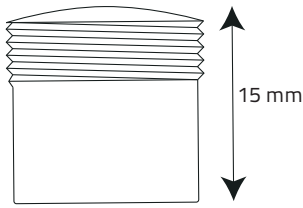

Heavy Wall Curved Face

- \varnothing 38-100mm pipe
- wall thickness >2.5mm
- 15mm hole with \varnothing 16mm x 1.8mm counterbore
- M16 x 1 internal thread

Thin Wall Curved Face

- \varnothing 38-100mm pipe
- wall thickness >1.5mm
- 15mm hole
- M16 x 1 internal thread

Heavy Wall Flat Face

- Flat surface
- wall thickness >2.5mm
- 15mm hole with \varnothing 16mm x 1.8mm counterbore
- M16 x 1 internal thread

Thin Wall Flat Face

- Flat surface
- wall thickness >1.5mm
- 15mm hole
- M16 x 1 internal thread

Lighting Data

LED Quantity	1
LED type	Cree
Power	1.5W
Colour temperature	Lumen output
5000K	140
4000K	130
3000K	119
2700K	110

Electrical Data

Input current	500mA
Vf	3V
Driver	Maxi Jolly HV 1-30 minipucks in series
Connection	waterproof gel filled connector
Wire size and distances	max OD 2.08mm
	<100m - 0.5mm ²
	<150m - 0.75mm ²
	<200m - 1mm ²
	<200m - 1.5mm ²

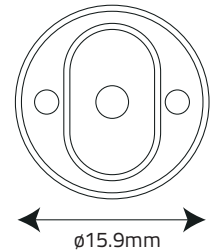
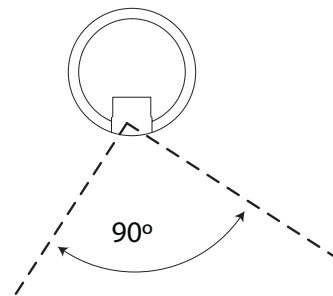

Fixture data

Metalware standard	316 stainless steel	
Metalware option	aluminium, brass, aged bronze patina, paint finish, hyper-duplex stainless steel	
Lens standard	polycarbonate lens	
Lens option	borosilicate lens	
IP rating	IP66	polycarbonate lens
	IP67	borosilicate lens
Impact rating	IK10 (polycarbonate lens)	
Ambient temperature	55°C	
Warranty	5 years	

Assymmetric Beam Heavy wall suitable for wall thickness >2.5mm Curved Face \varnothing 38-1000mm handrail pipe

HLS-VA-HW-CF-DW	Standard, Heavy Wall, Curved, Face, 5000K
HLS-VA-HW-CF-NW	Standard, Heavy Wall, Curved Face, 4000K
HLS-VA-HW-CF-WW	Standard, Heavy Wall, Curved Face, 3000K
HLS-VA-HW-CF-IW	Standard, Heavy Wall, Curved, Face 2700K

Assymmetric Beam Thin wall suitable for wall thickness >1.5mm Curved Face \varnothing 38-1000mm handrail pipe

HLS-VA-TW-CF-DW	Standard, Thin Wall, Curved, Face 5000K
HLS-VA-TW-CF-NW	Standard, Thin Wall, Curved Face, 4000K
HLS-VA-TW-CF-WW	Standard, Thin Wall, Curved Face, 3000K
HLS-VA-TW-CF-IW	Standard, Thin Wall, Curved Face, 2700K

Assymmetric Beam Heavy wall suitable for wall thickness >2.5mm Flat Face Surface

HLS-VA-HW-FF-DW	Standard, Heavy Wall, Flat Face, 5000K
HLS-VA-HW-FF-NW	Standard, Heavy Wall, Flat Face, 4000K
HLS-VA-HW-FF-WW	Standard, Heavy Wall, Flat Face, 3000K
HLS-VA-HW-FF-IW	Standard, Heavy Wall, Flat Face, 2700K

Assymmetric Beam Thin wall suitable for wall thickness >1.5mm Flat Face Surface

HLS-VA-TW-FF-DW	Standard, Thin Wall, Flat Face, 5000K
HLS-VA-TW-FF-NW	Standard, Thin Wall, Flat Face, 4000K
HLS-VA-TW-FF-WW	Standard, Thin Wall, Flat Face, 3000K
HLS-VA-TW-FF-IW	Standard, Thin Wall, Flat Face, 2700K

